

NOTE:  
IT IS THE RESPONSIBILITY OF THE  
DESIGNER / END USER TO VERIFY THAT  
STRUCTURES BUILT WITH ECO-BLOCK  
HAVE BEEN DESIGNED, ENGINEERED, AND  
CONSTRUCTED IN ACCORDANCE WITH ALL  
APPLICABLE BUILDING CODES AND REGULATIONS

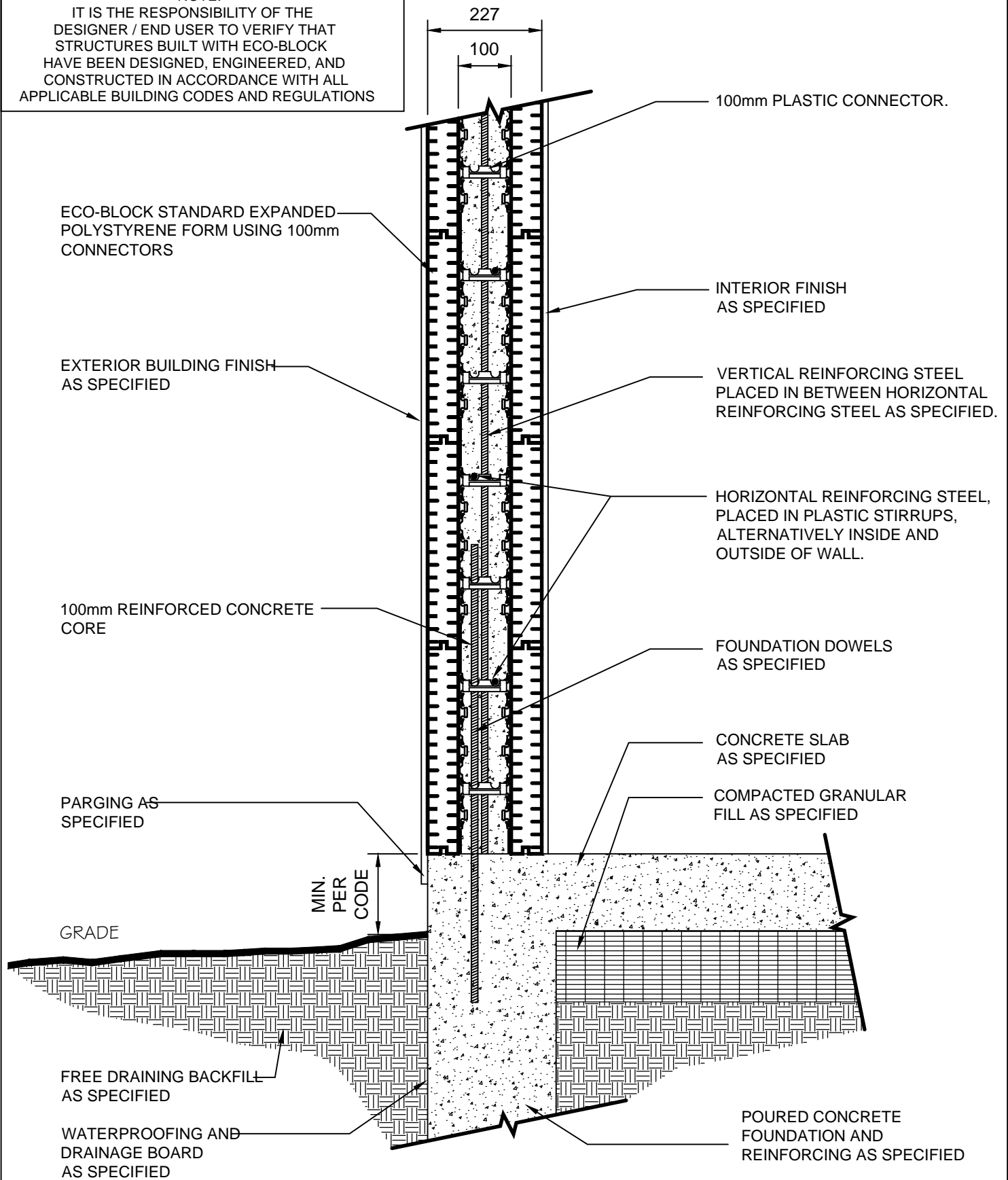

# Eco-Block, NZ

ICF SOLUTIONS LTD.  
PAUL JONES  
FREE PHONE 0508 ECOICF (0508 326 423)  
P.O. BOX 11  
PAPAMOA 3151  
WWW.ECOICF.CO.NZ

## 230mm Eco-Block System

TYPICAL CONCRETE STEM WALL  
WALL 100MM FORMS ABV. GRADE

ICF SOLUTIONS LIMITED

DATE: 2.3.15

SCALE: 1:10

REVISION:

DRAWING NUMBER:

ECO-BLOCK-039